

Smart intralogistics solution



Robotics and Automation

Pallet mover across factory and warehouse

FEATURES

AR Pallet Mover: A-B-C-...-A Loop with manual loading and unloading

AR Pallet Mover transports pallets along the loop continuously and workers are allowed to load or unload goods manually on the way. Pause on pre-programmed workstations.

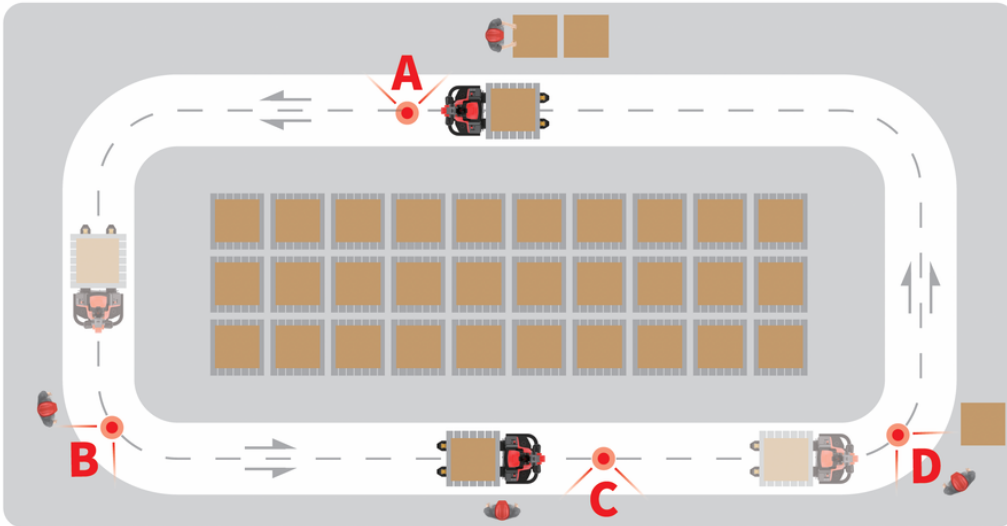

AR Pallet Mover+: A-B-A with automatic unloading

AR Pallet Mover starts with manual loading and unloads pallets automatically in the storage area or production. It requires minimum involvement of workers and delivers high process efficiency where transportation tasks need to be repeated permanently.

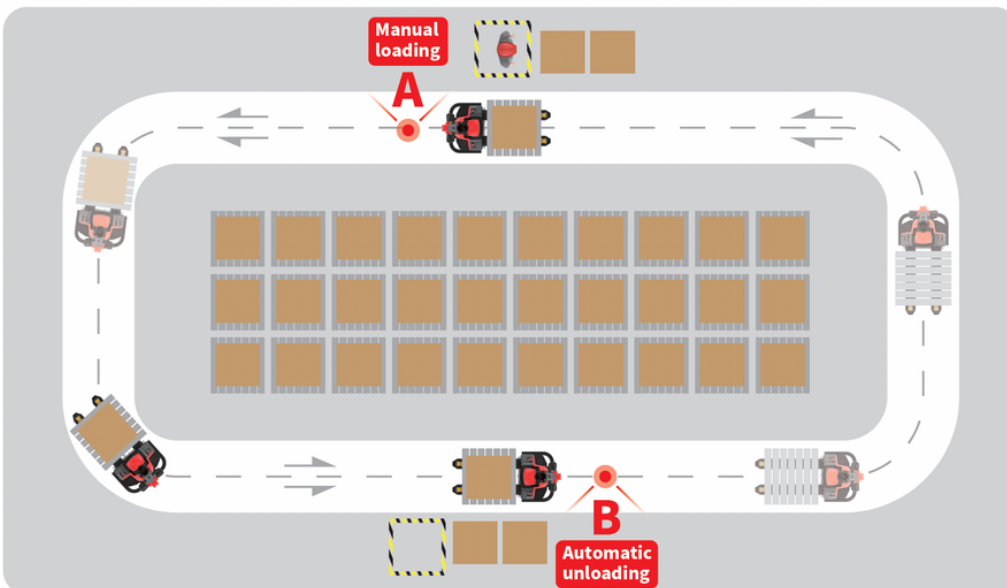

FEATURES

Your best co-worker

You can operate AR Pallet Mover as an autonomous mobile robot and an electric pallet truck. Switch between manual and automatic operation by the push of a button.

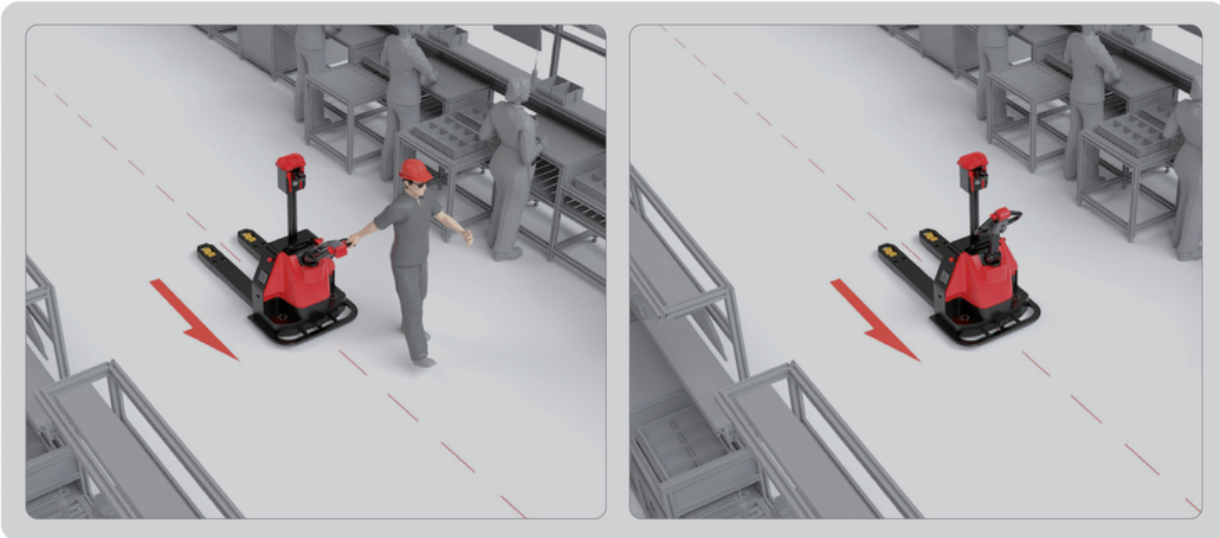

Stand alone installation

The AR Pallet Mover is easy to set up for various applications without IT knowledge or specialized hardware and software.

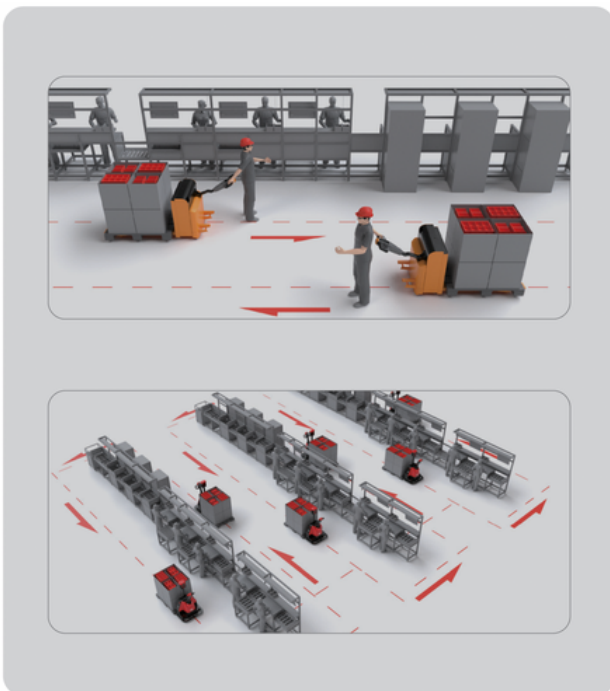

Flexible to change application

The AR Pallet Mover offers route settings and transportation task monitoring via bluetooth and you can add new routes and stations quickly on your phone.

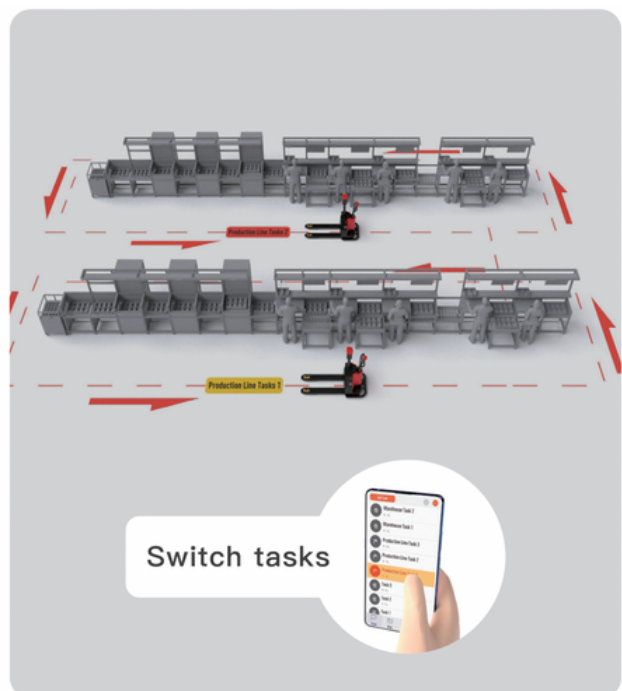

FEATURES

Plug-in battery design

The AR Pallet Mover features plug-in battery design and adopts a standard battery box with 24V/60Ah Li-ion battery. This maximizes uptime and provides high availability and flexibility.



2D visual navigation

Our in-house developed visual navigation technology provides AR Pallet Mover with highly stable and adaptable navigation. Absolute positioning, with random labeling and visual navigation, the vehicle knows its position at all times to proceed its path.

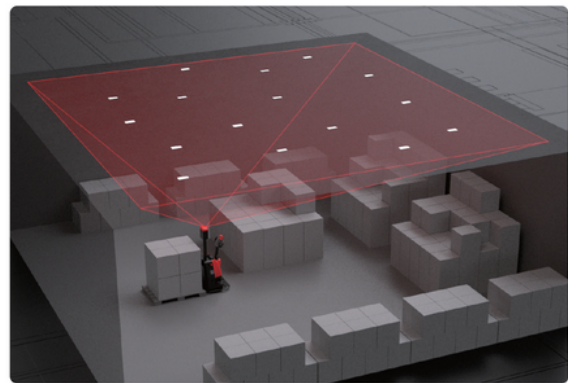

Maximum personal safety protection

The AR Pallet Mover is equipped with Bumper strips and Lidar detectors that prevent the truck from collisions.

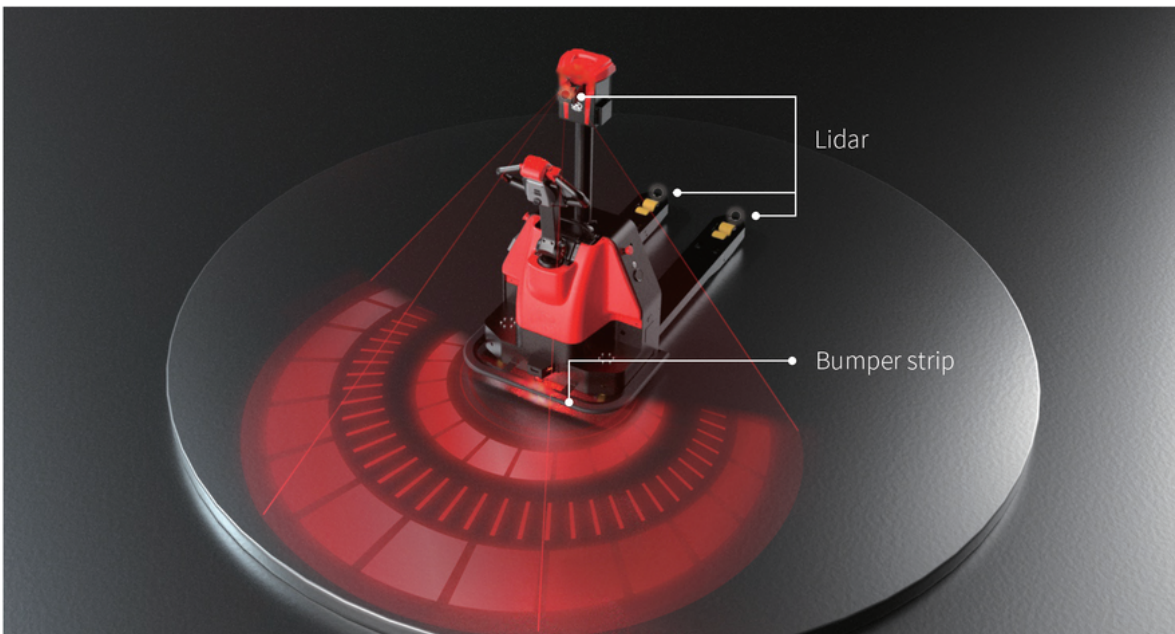

CONTACT US

 enquiry@airobot.com.sg

 www.airobot.com.sg

 (65) 6844 0288